

- A - EASEMENT TO DRAIN SEWAGE 4 WIDE (DP1070242)
- B - EASEMENT TO DRAIN SEWAGE 3 WIDE (DP1070242)
- E - EASEMENT TO DRAIN SEWAGE 3 WIDE (DP1204011)
- H - EASEMENT TO DRAIN SEWAGE 3 WIDE (DP1104415)
- J - EASEMENT TO DRAIN WATER 3.5 WIDE (DP1210091)
  
- AB - EASEMENT FOR DRAINAGE SEWAGE OF VARIABLE WIDTH
- AC - RIGHT OF CARRIAGEWAY VARIABLE WIDTH
- AD - EASEMENT FOR DRAINAGE OF WATER VARIABLE WIDTH
- AE - EASEMENT FOR DRAINAGE OF SEWAGE 4 WIDE
- AG - EASEMENT FOR UNDERGROUND ELECTRICITY 2 WIDE
- AH - EASEMENT FOR MULTI-PURPOSE ELECTRICAL INSTALLATION
- AI - RIGHT OF CARRIAGEWAY VARIABLE WIDTH
- AJ - RESTRICTION ON THE USE OF LAND
- AK - RESTRICTION ON THE USE OF LAND
- AL - RIGHT OF CARRIAGEWAY 3 WIDE
- AM - EASEMENT FOR MULTI-PURPOSE ELECTRICAL INSTALLATION
- AN - EASEMENT FOR DRAINAGE OF WATER 4 WIDE
- AO - EASEMENT FOR REPAIRS 3 WIDE

THIS PLAN IS PRELIMINARY AND THE INFORMATION AND DIMENSIONS SHOWN MAY VARY TO THE FINAL PLAN TO BE LODGED WITH COUNCIL

Surveyor: Date of Survey: Surveyors Ref: 180219	<b>PLAN OF SUBDIVISION OF LOT 2 DP1222425</b>	LGA: TWEED Locality: MURWILLUMBAH Subdivision No.: Lengths are in metres. Reduction Ratio 1:500	Registered  <b>DP DRAFT</b>
---	---	--	-----------------------------------

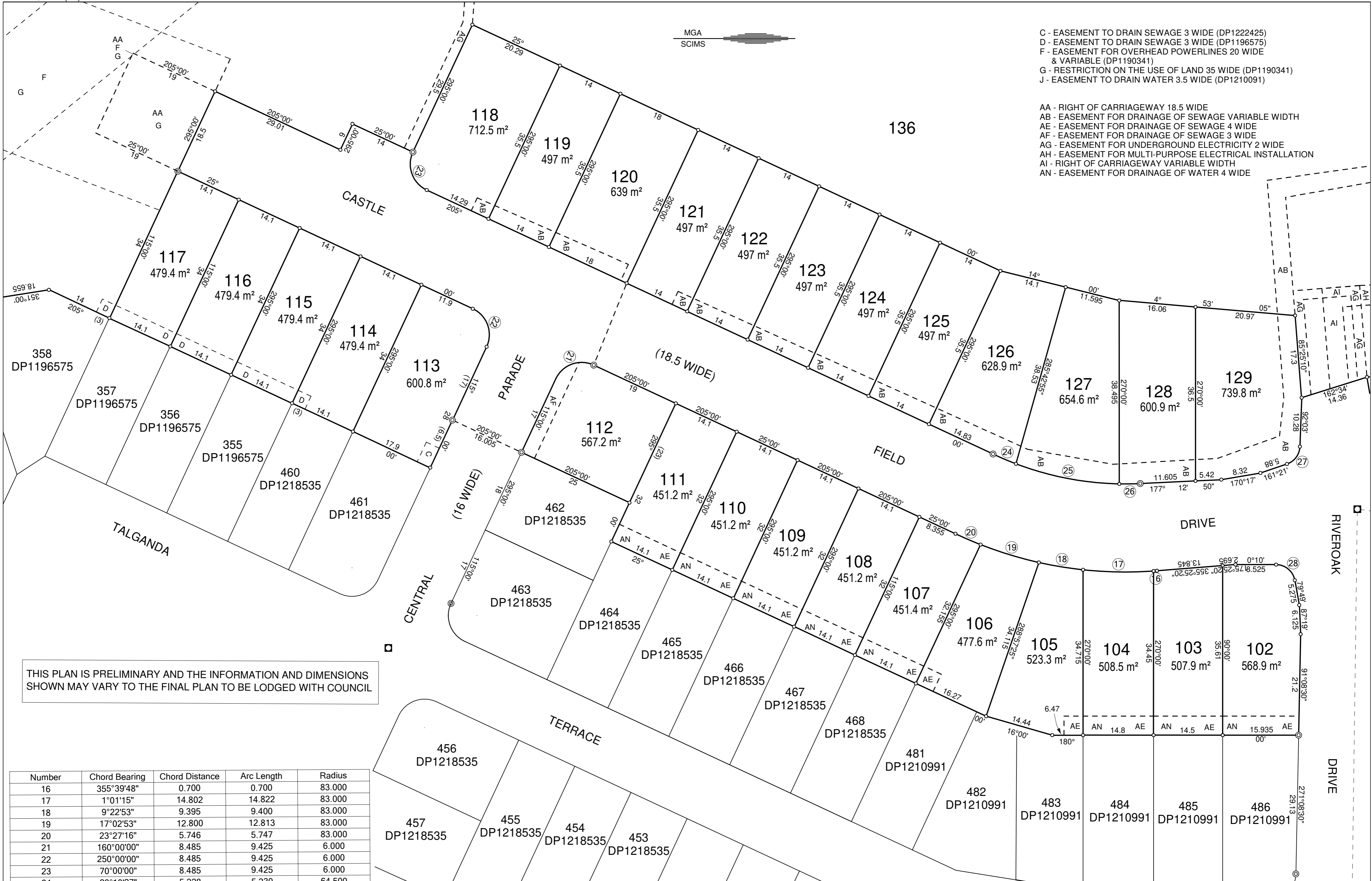

- C - EASEMENT TO DRAIN SEWAGE 3 WIDE (DP1222425)
- D - EASEMENT TO DRAIN SEWAGE 3 WIDE (DP1196575)
- F - EASEMENT FOR OVERHEAD POWERLINES 20 WIDE & VARIABLE (DP1190341)
- G - RESTRICTION ON THE USE OF LAND 35 WIDE (DP1190341)
- J - EASEMENT TO DRAIN WATER 3.5 WIDE (DP1210091)
  
- AA - RIGHT OF CARRIAGEWAY 18.5 WIDE
- AB - EASEMENT FOR DRAINAGE OF SEWAGE VARIABLE WIDTH
- AE - EASEMENT FOR DRAINAGE OF SEWAGE 4 WIDE
- AF - EASEMENT FOR DRAINAGE OF SEWAGE 3 WIDE
- AG - EASEMENT FOR UNDERGROUND ELECTRICITY 2 WIDE
- AH - EASEMENT FOR MULTI-PURPOSE ELECTRICAL INSTALLATION
- AI - RIGHT OF CARRIAGEWAY VARIABLE WIDTH
- AN - EASEMENT FOR DRAINAGE OF WATER 4 WIDE

THIS PLAN IS PRELIMINARY AND THE INFORMATION AND DIMENSIONS SHOWN MAY VARY TO THE FINAL PLAN TO BE LODGED WITH COUNCIL

Number	Chord Bearing	Chord Distance	Arc Length	Radius
16	355°39'48"	0.700	0.700	83.000
17	1°01'15"	14.802	14.822	83.000
18	9°22'53"	9.395	9.400	83.000
19	17°02'53"	12.800	12.813	83.000
20	23°27'16"	5.746	5.747	83.000
21	160°00'00"	8.485	9.425	6.000
22	250°00'00"	8.485	9.425	6.000
23	70°00'00"	8.485	9.425	6.000
24	23°10'27"	5.228	5.230	64.500
25	10°59'28"	22.091	22.200	64.500
26	359°10'19"	4.409	4.410	64.500
27	306°42'00"	4.550	4.840	4.000
28	219°59'00"	5.125	5.562	4.000

Surveyor: Date of Survey: Surveyors Ref:	<b>PLAN OF SUBDIVISION OF LOT 2 DP1222425</b>	LGA: TWEED Locality: MURWILLUMBAH Subdivision No.: Lengths are in metres. Reduction Ratio 1:500	Registered  <b>DP</b>
--	---	--	-----------------------------